

- NOTES:**
1. THIS DRAWING IS FOR PLANNING APPLICATION PURPOSES ONLY.
 2. DRAWING NOT TO BE SCALED. FIGURED DIMENSIONS ONLY TO BE USED.
 3. ALL LEVELS ARE METRES ABOVE MALIN HEAD DATUM.
 4. PLANS AND LAYOUT DRAWINGS SHOW PRINCIPLE FEATURES AND STRUCTURES OF THE SITE, AS WITH ALL INDUSTRIAL SITES, ON-GOING OPERATIONS AND MAINTENANCE OCCASIONALLY NECESSITATE THE TEMPORARY USE OF MODULAR UNITS SUCH AS PORTACABINS FOR WELFARE FACILITIES, STORAGE ETC. THEIR USE IS TYPICALLY SHORT-TERM, RELATED TO PARTICULAR ACTIVITIES AND DOES NOT CHANGE THE NATURE OR INTENSITY OF ACTIVITIES ON THE SITE

LEGEND

PLANNING APPLICATION BOUNDARY:	
EXISTING GROUND LEVEL (MOD):	+44.50
EXISTING TREES:	
EXISTING BUILDING:	

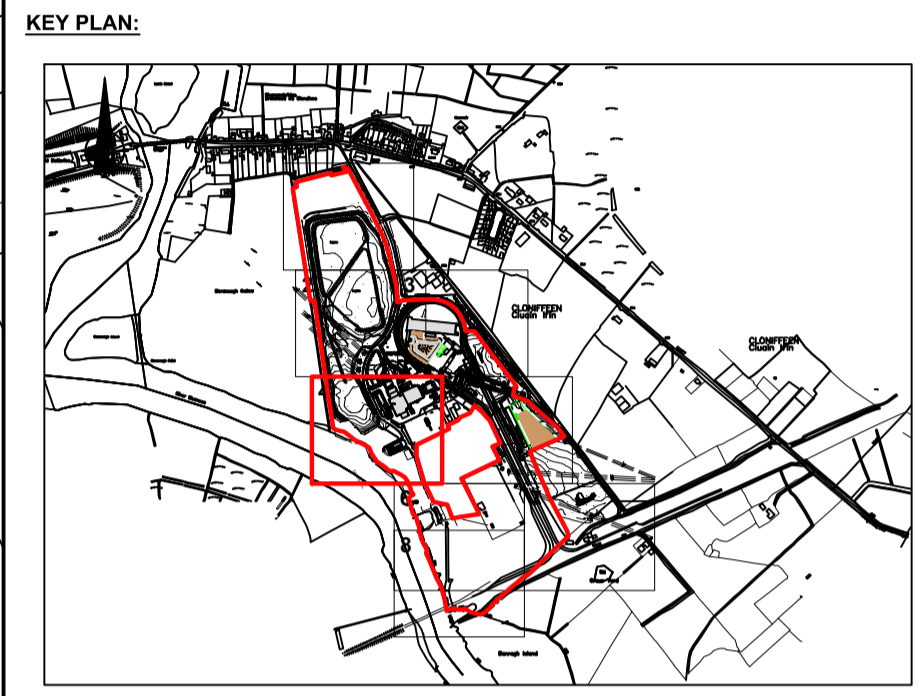

This Drawing utilised Ordnance Survey map sheet numbers 3425A & 3425.

Ordnance Survey Licence No. EN 0023715-19, Copyright Ordnance Survey Ireland, Government of Ireland

REV	DATE	REVISION DESCRIPTION	DRN	VER	APP	DRN	VER	APP
0	18.10.18	ISSUED FOR PLANNING	KMcG	HOK	PK	NH	DK	

COPYRIGHT © ESB INTERNATIONAL LIMITED
ALL RIGHTS RESERVED. NO PART OF THIS WORK MAY BE MODIFIED, REPRODUCED OR COPIED IN ANY FORM OR BY ANY MEANS - GRAPHIC, ELECTRONIC OR MECHANICAL, INCLUDING PHOTOCOPYING, RECORDING, TAPING OR USED FOR ANY PURPOSE OTHER THAN ITS DESIGNATED PURPOSE, WITHOUT THE WRITTEN PERMISSION OF ESB ENGINEERING & FACILITY MANAGEMENT LTD. TRADING AS ESB INTERNATIONAL.

PURPOSE OF ISSUE - PRELIMINARY UNLESS INDICATED

CLIENT APPROVAL PLANNING TENDER CONSTRUCTION AS-BUILT

CLIENT: ESB

PROJECT: WEST OFFALY POWER TRANSITION TO BIOMASS

ENGINEER DESIGN: **BORDNAMONA** Naturally Driven
Engineering Department, Leabog, Tullamore, Co. Offaly Tel: 057 9345900

CONTRACT: WOP - TRANSITION TO BIOMASS

DRAWING TITLE: WOP LAYOUT EXISTING & PROPOSED SHEET 4 OF 8

PRODUCTION UNIT: CIVIL & ENVIRONMENTAL ENGINEERING

ESB INTERNATIONAL One Dublin Airport Central, Dublin Airport, Cloughran, Co. Dublin
Tel: 353 1 703 8000 Email: marketing@esbi.ie
Web: www.esbinternational.ie
ESB International is a trading name of ESB Engineering & Facility Management Ltd. Registered Office: as above Registered in Ireland No. 155249

DRAWN: KMcG	VERIFIED: HOK	APPROVED: PK	APPROVAL DATE: 18.10.18
CLIENT REF:	NO. OF SHTS: 1	SIZE: A1	SCALE: 1:500

DRAWING NUMBER: QS-00206-01-D460-028 REV: 0